

Electrical specifications

Frequency Range	2 – 18	[GHz]
VSWR (max.)	≤ 2	–
S₁₁ (max.)	≤ -10	[dB]
Impedance	50	[Ω]
Connector	SMA	–
Power (CW)	–	[W]
Power (Impulse)	–	[W]
Gain	6 – 17	[dBi]
Polarization	Linear	–

Physical specifications

W x L x H	119 x 119 x 86	[mm ³]
Weight	180	[g]



Technical Drawing

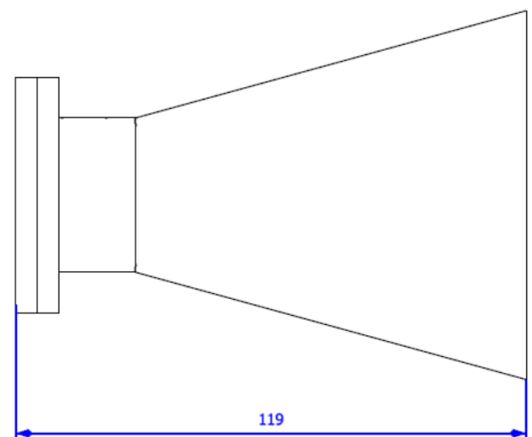
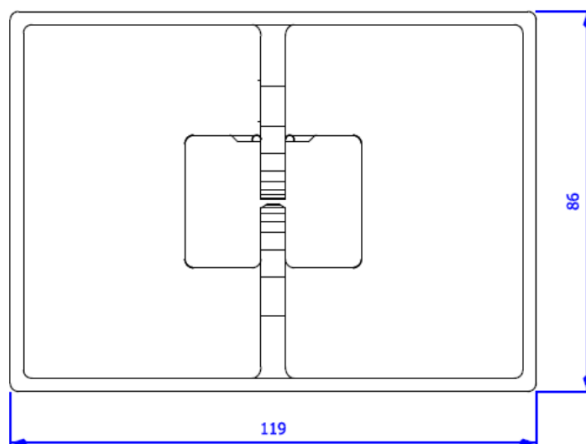



TEM Horn
2 – 18 GHz

Antenna

Reflexion coefficient

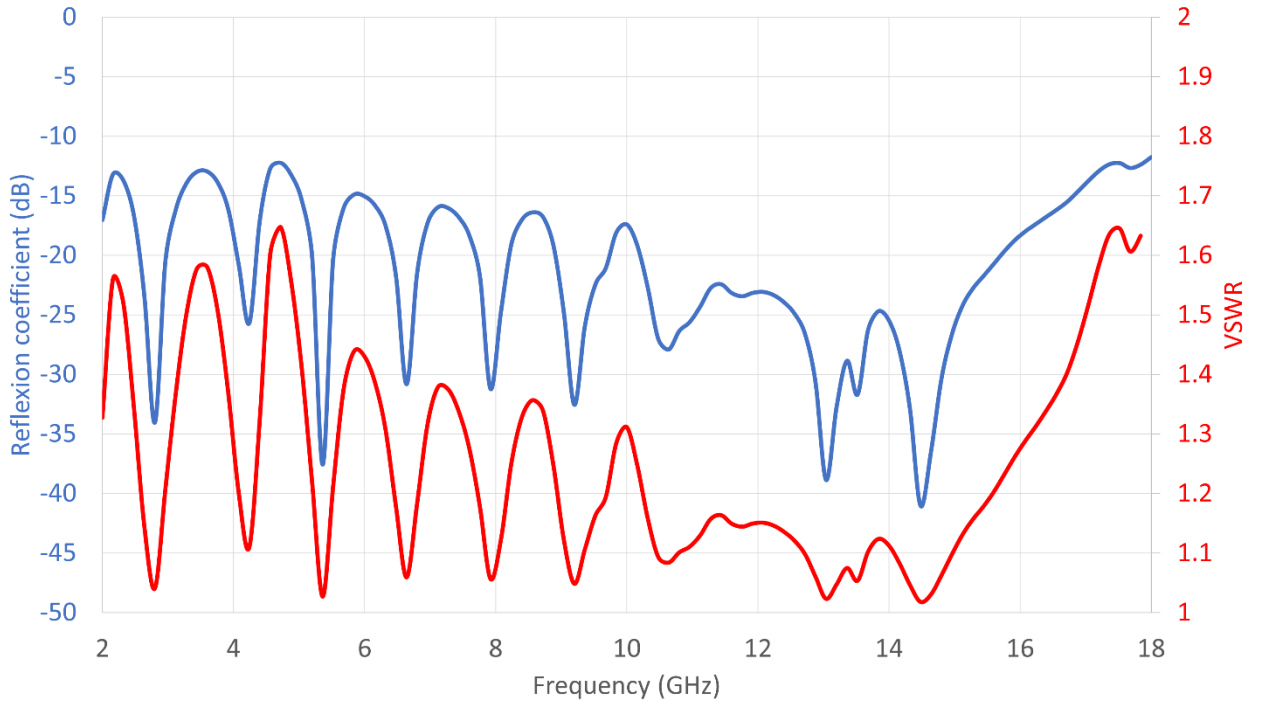

Gain

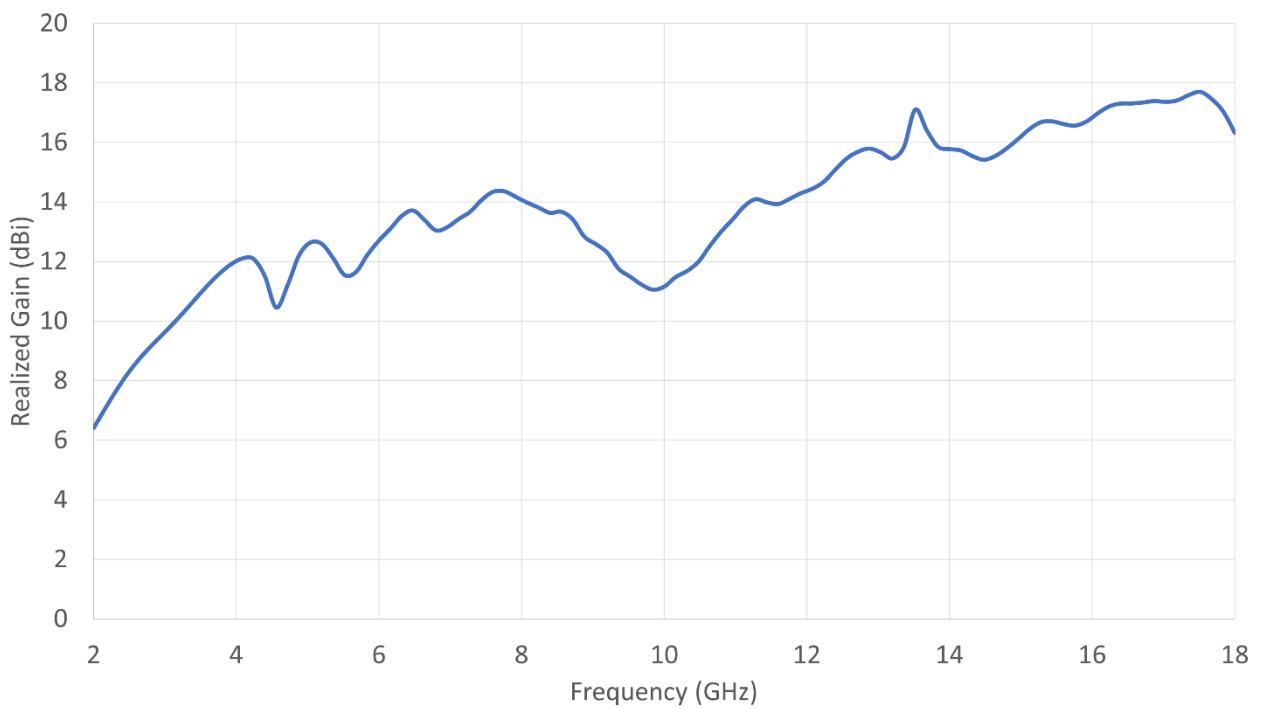

Antenna Factor

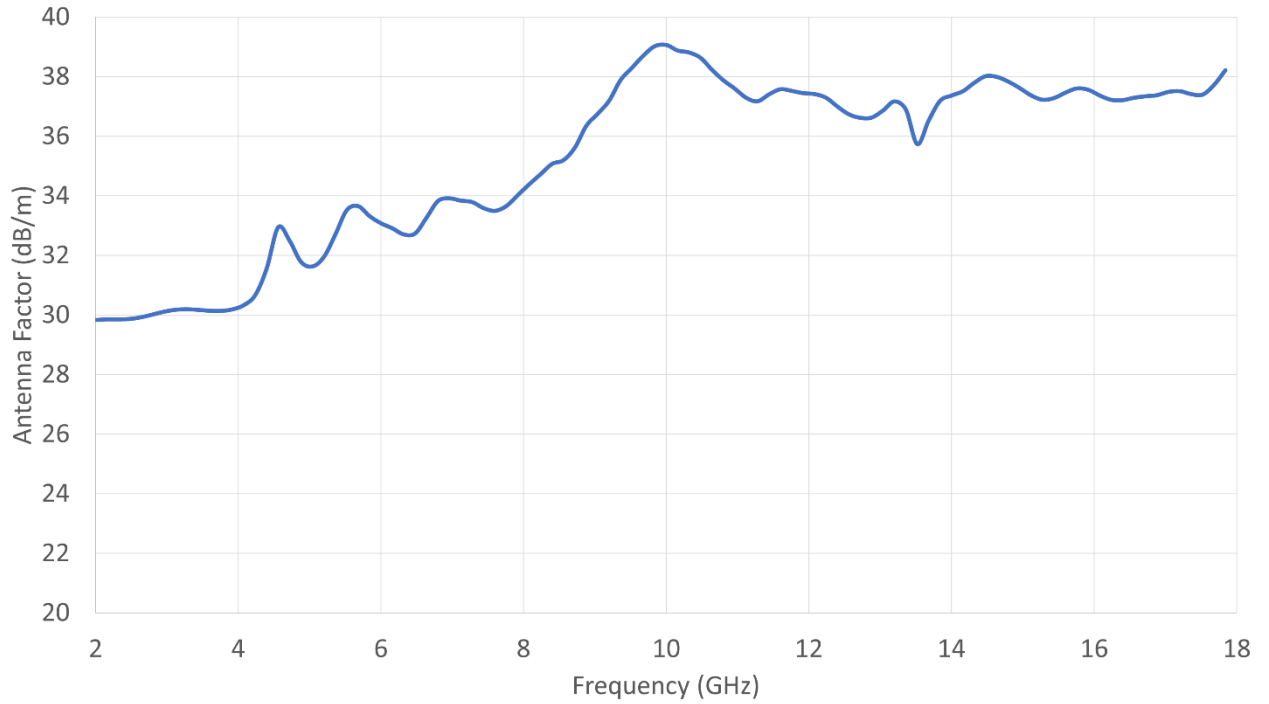

Cross. Pol. Rejection

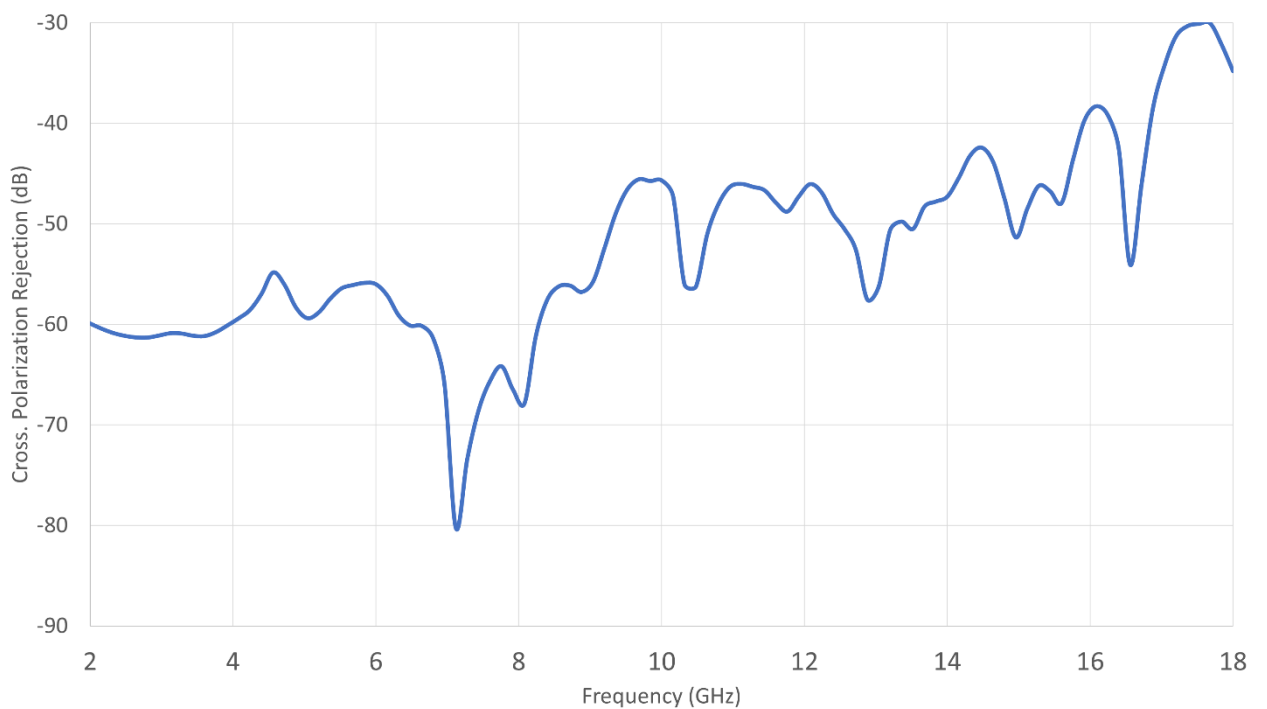



Radiation patterns

2 GHz

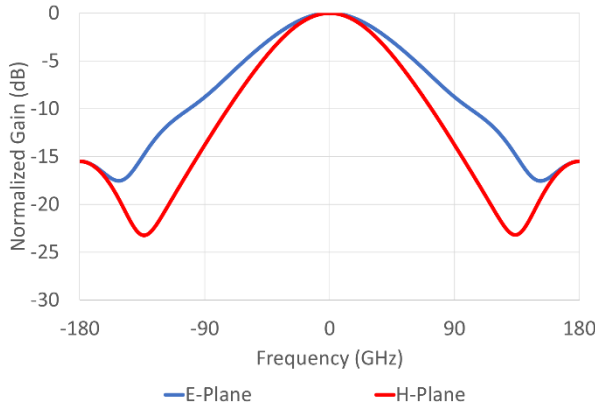

7.3 GHz

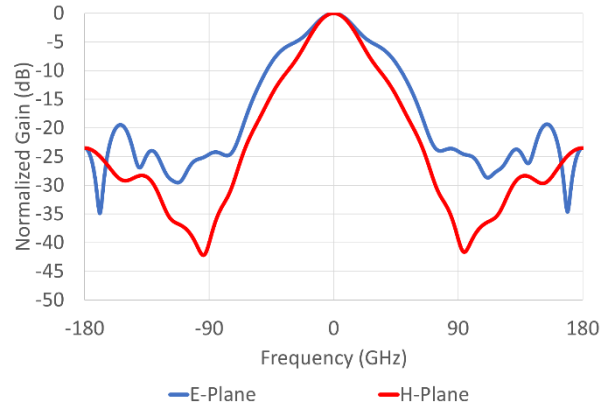

12.7 GHz

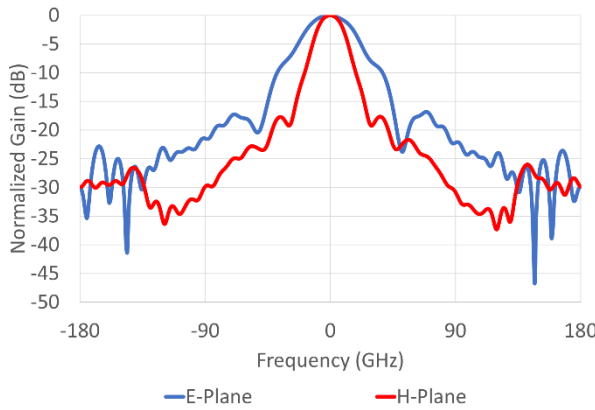

18 GHz

